

1

# ROM wipe 7022 to zTV modus

STB is running (connected with TV via HDMI and powered up)

1. Insert pin in reset hole at backside of STB and watch screen
2. When you see screen go black release pin (this is not a factory reset but a ROM wipe)
3. Wait until you see lower picture to pair the RCU
4. Follow steps mentioned onscreen to pair your RCU with the settopbox.

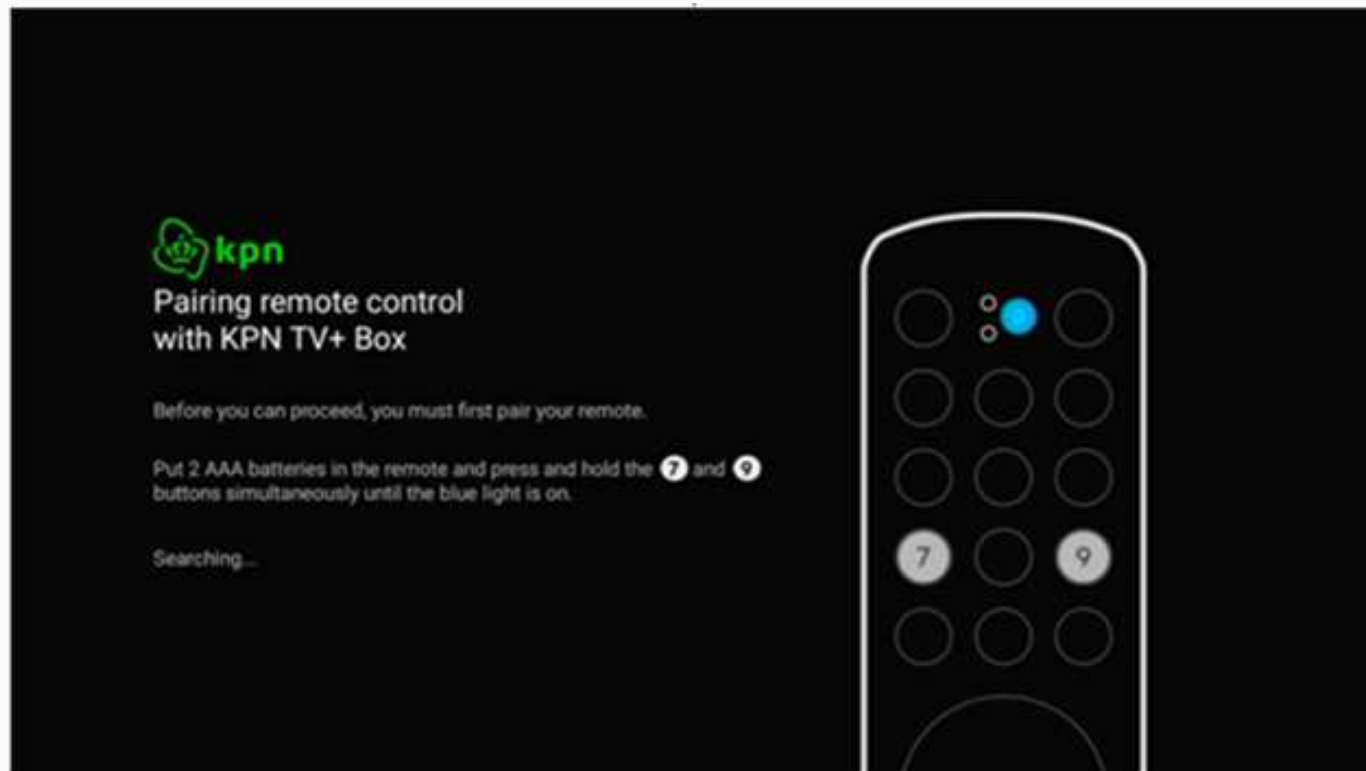

1 DIW7022 switch to zTV-mode via 988

2

# ROM wipe 7022 to zTV modus

Press OK to acknowledge Dutch language.

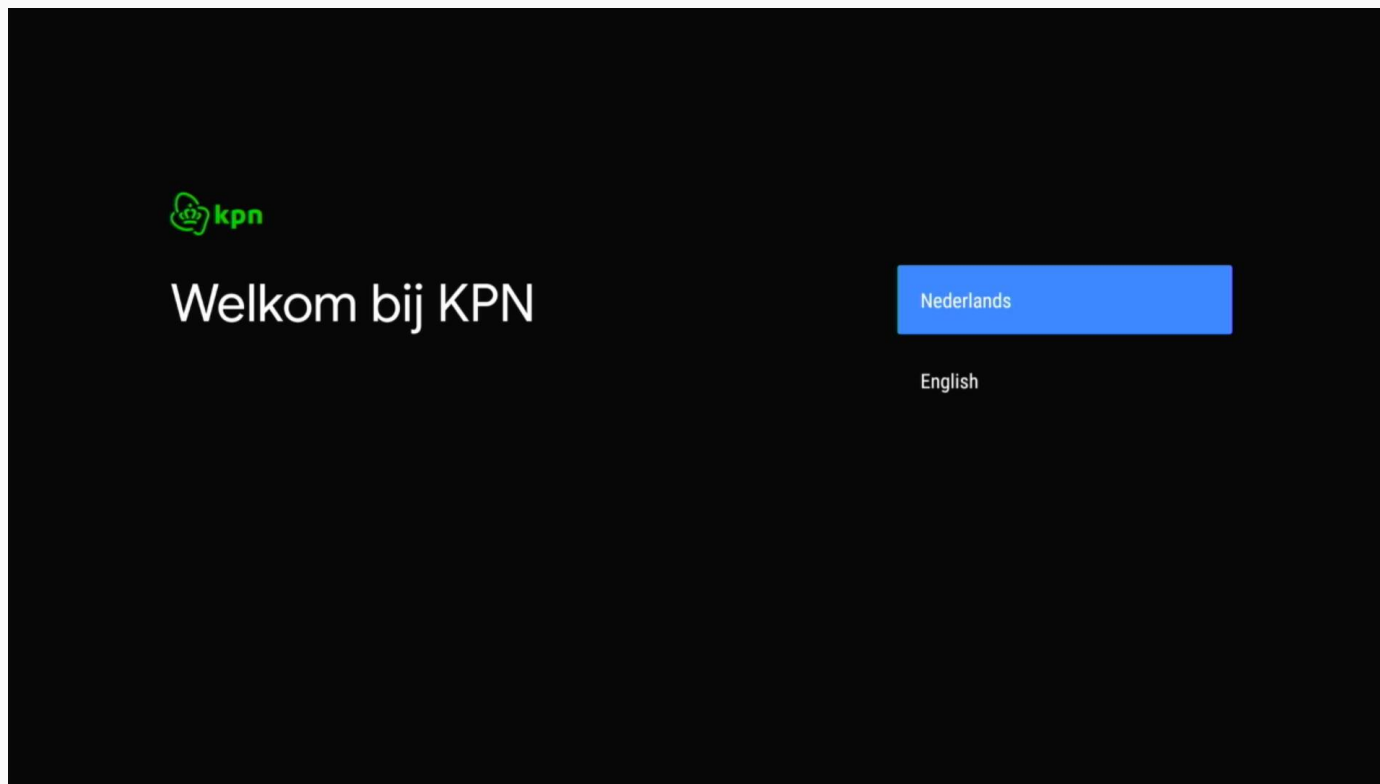

3

# ROM wipe 7022 to zTV modus

Press OK to acknowledge used connection.



4

# ROM wipe 7022 to zTV modus

Software update checks will be performed now automatically.

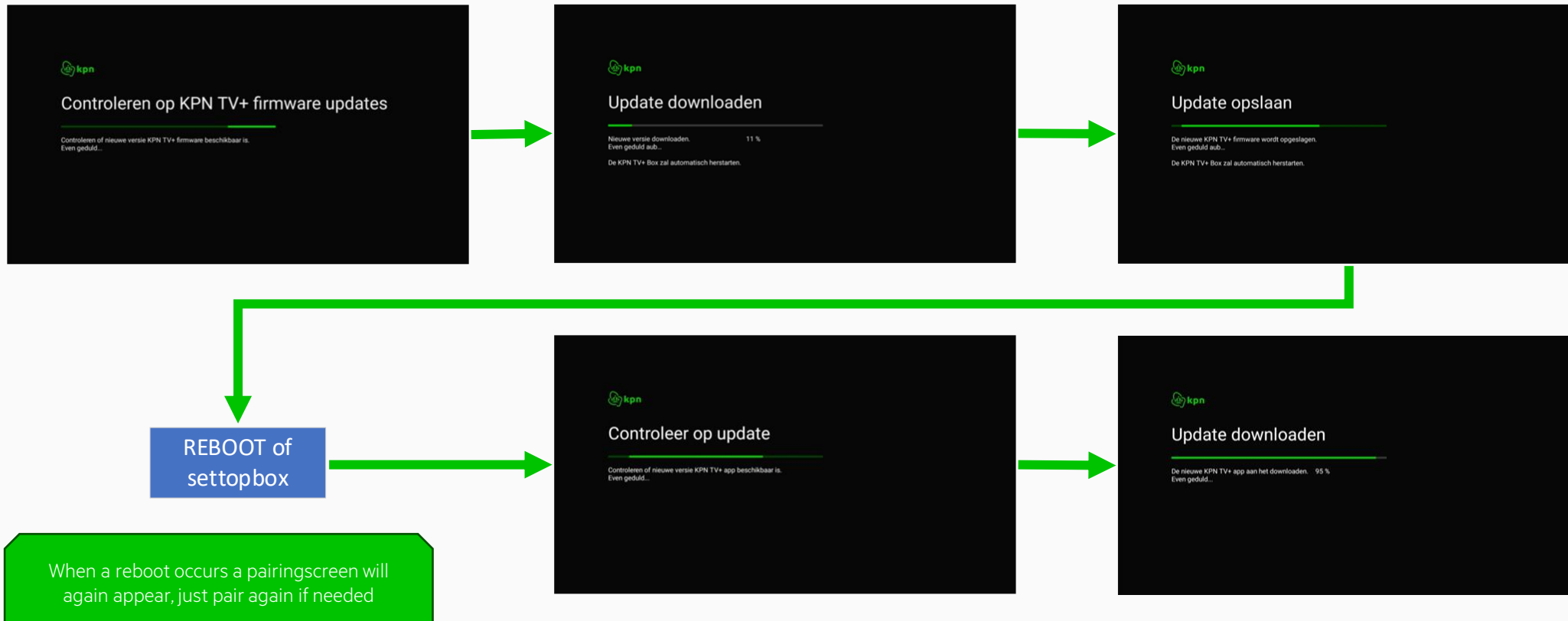

6

# ROM wipe 7022 to zTV modus

The update process stops in this (or similar) screen where no new software is found:

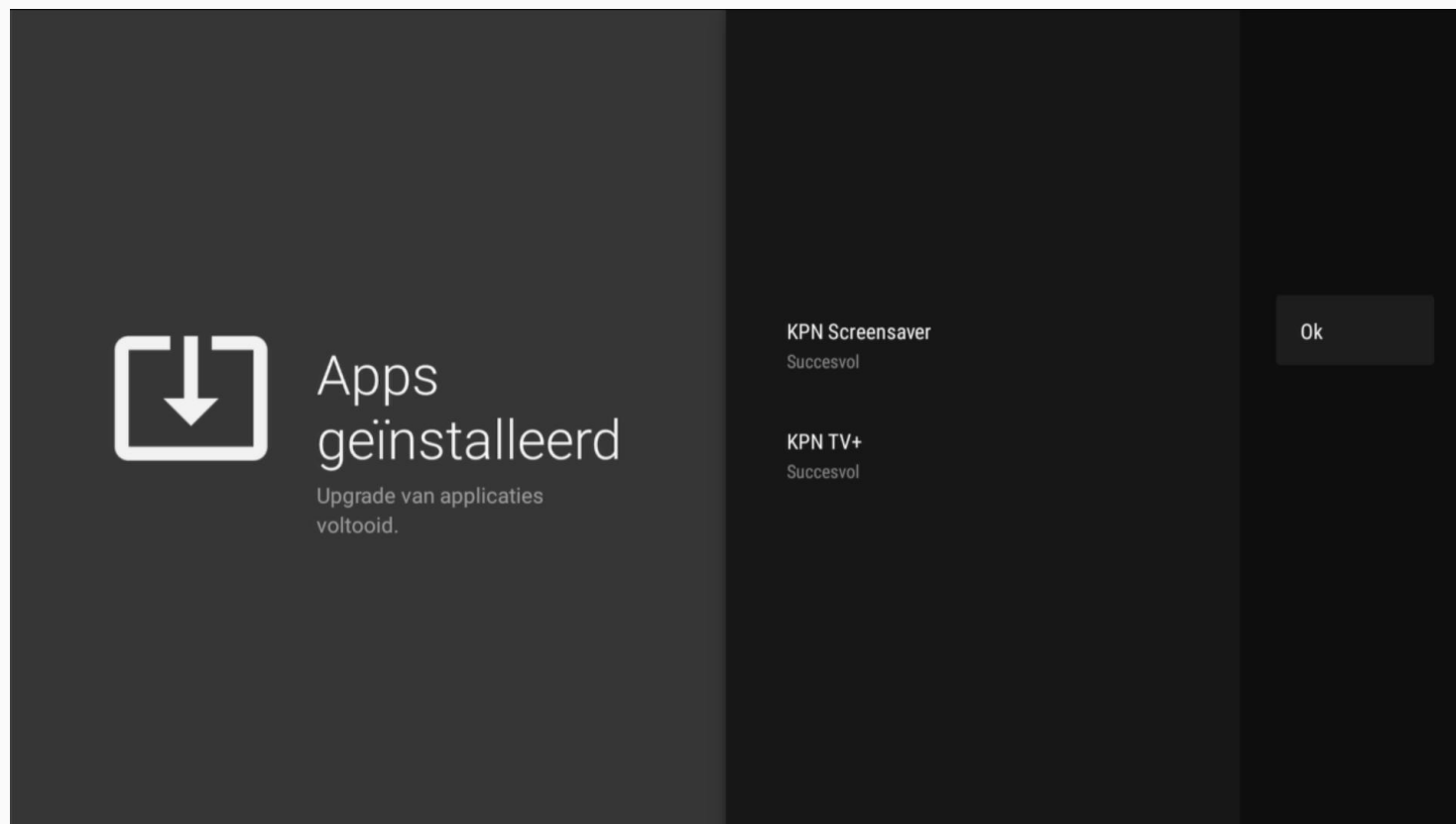

Now press number **988**. Onscreen you will see a short popup that hotelmode is enabled! If not press again 988 until you do. Then press OK to proceed.

7

# ROM wipe 7022 to zTV modus

Now the box will be in zTV mode and show login screen or playout when already logged in with a zTV account.

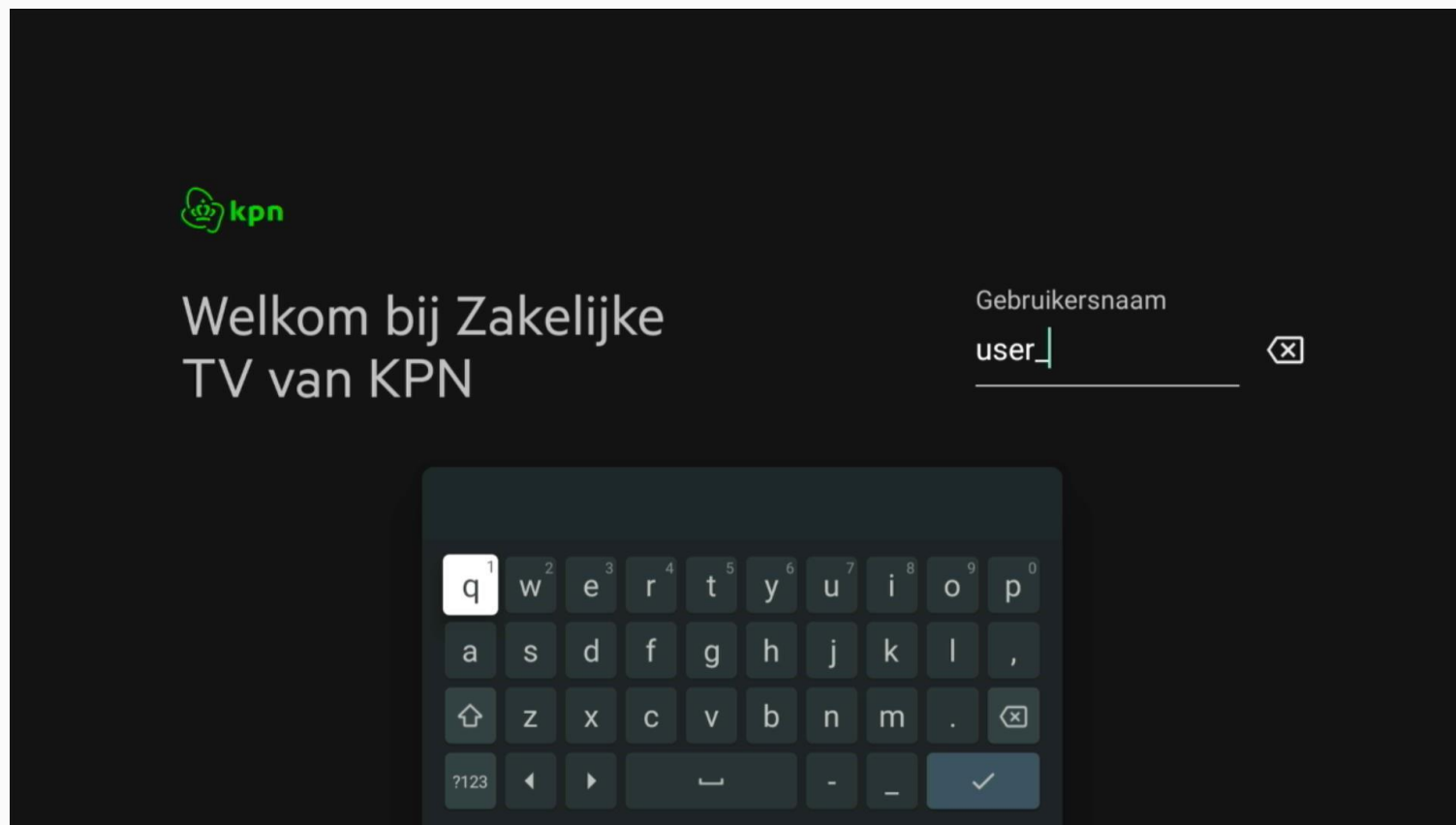

6 DIW7022 switch to zTV-mode via 988